











Project	06
Approach	24
Work in Progress	26
Construction	36
Appropriation	58



















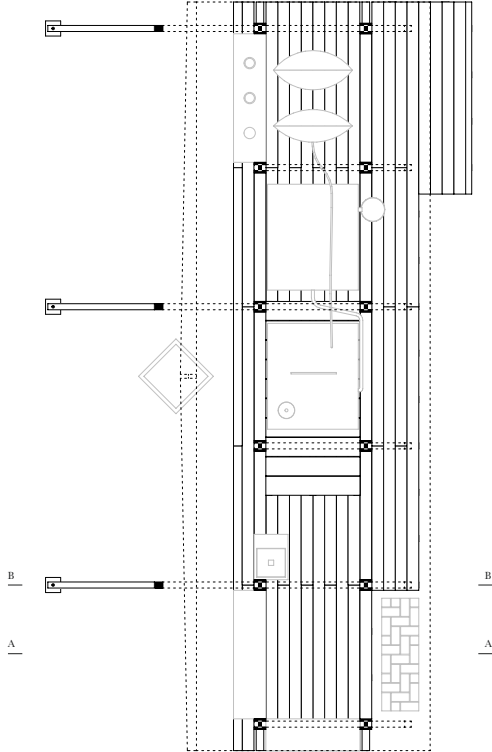
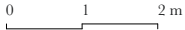











0 1 2 m

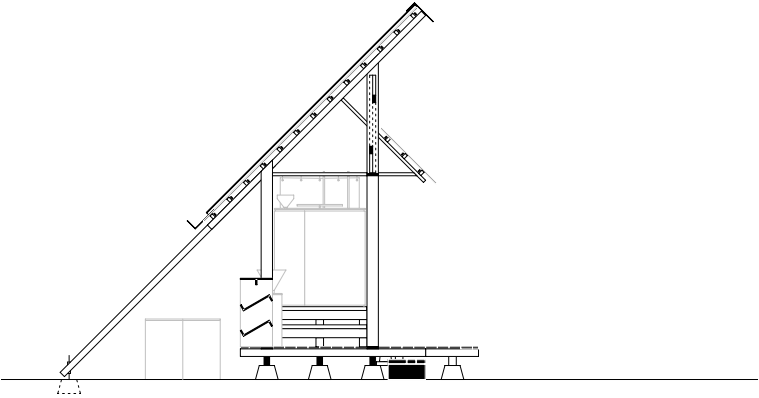







0 1 2 m

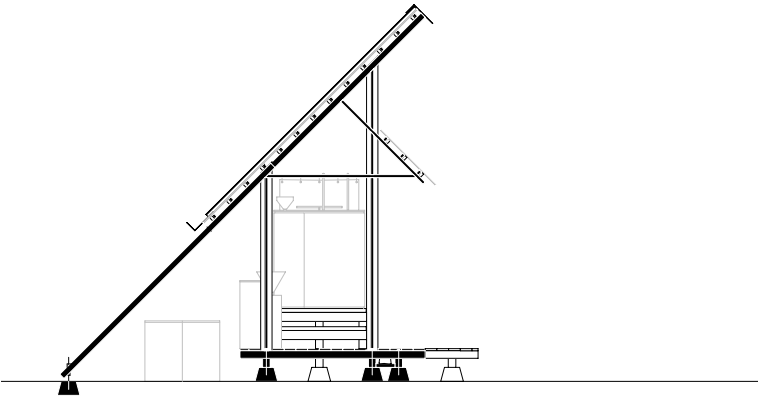

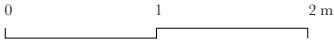
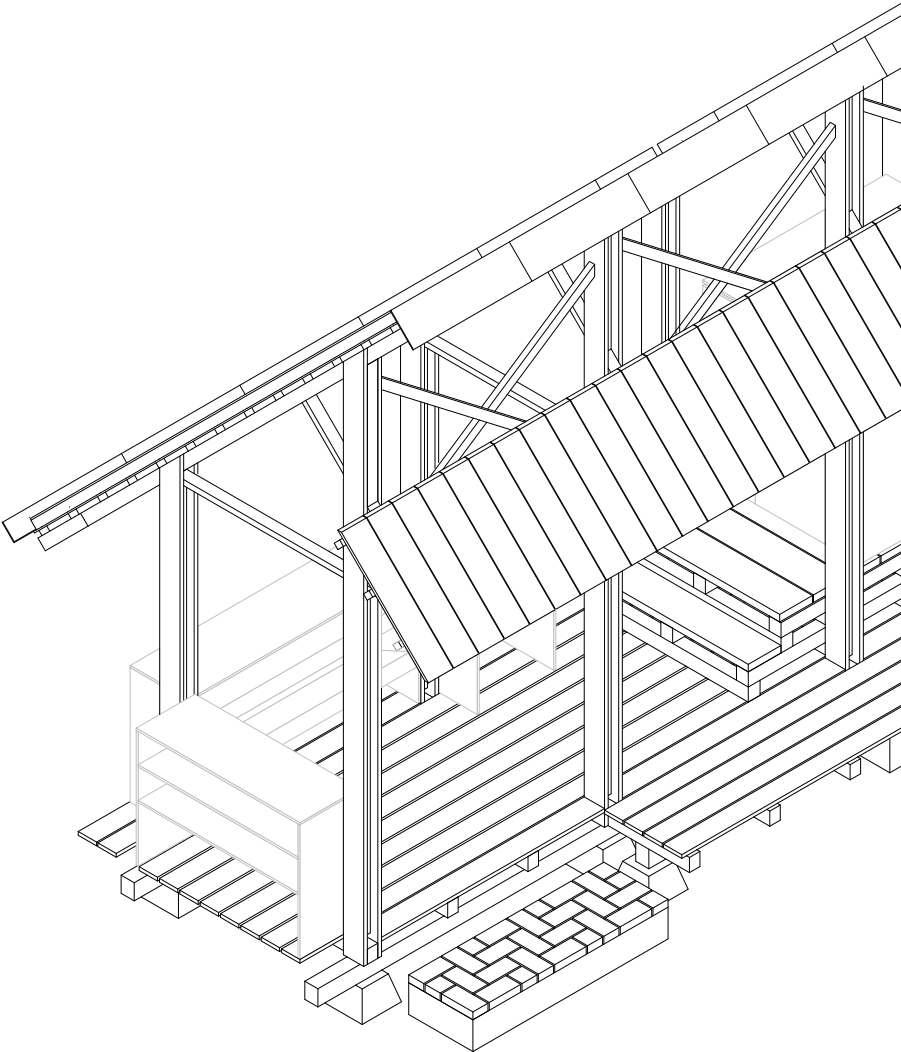

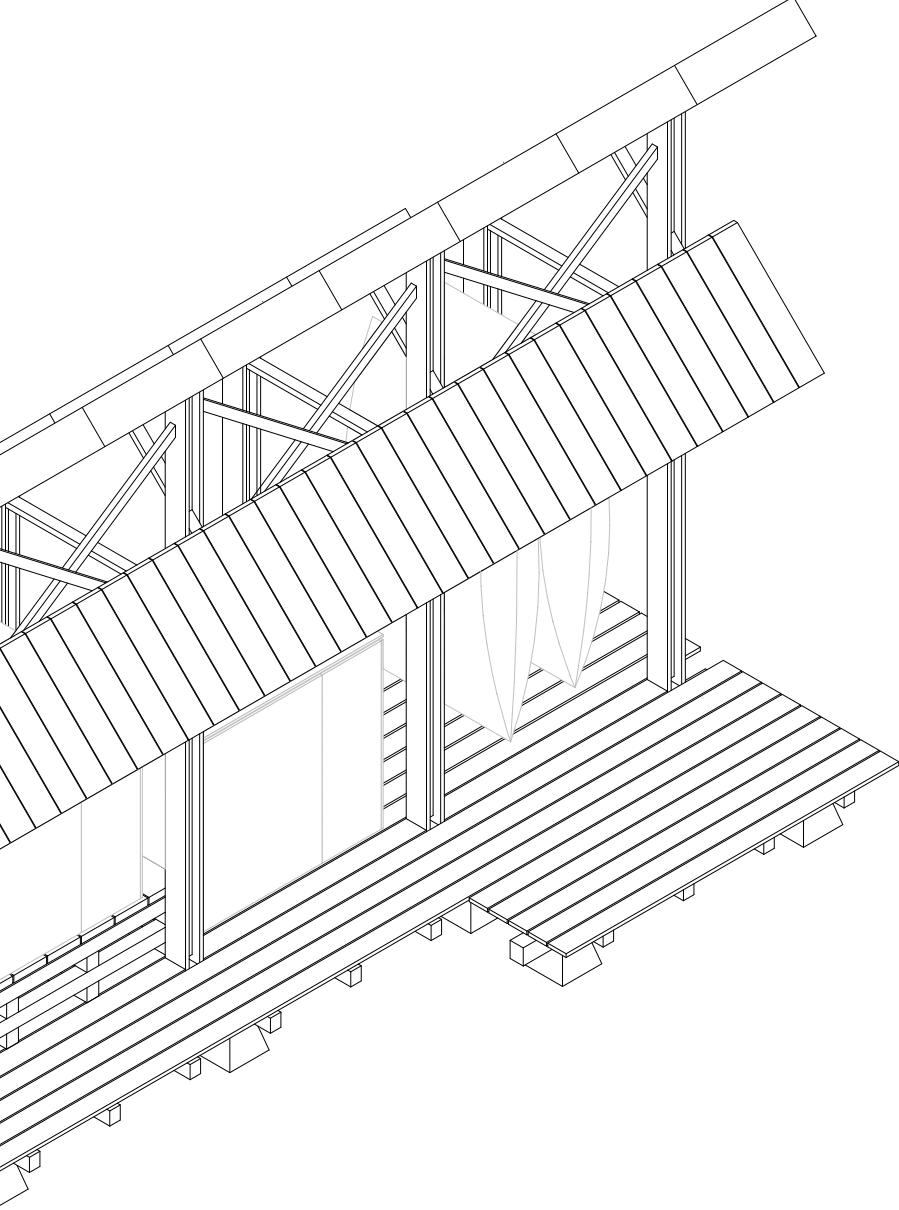

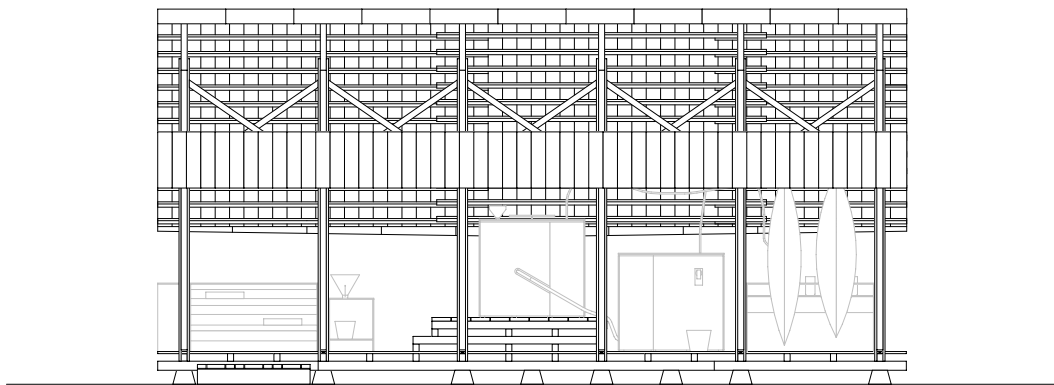







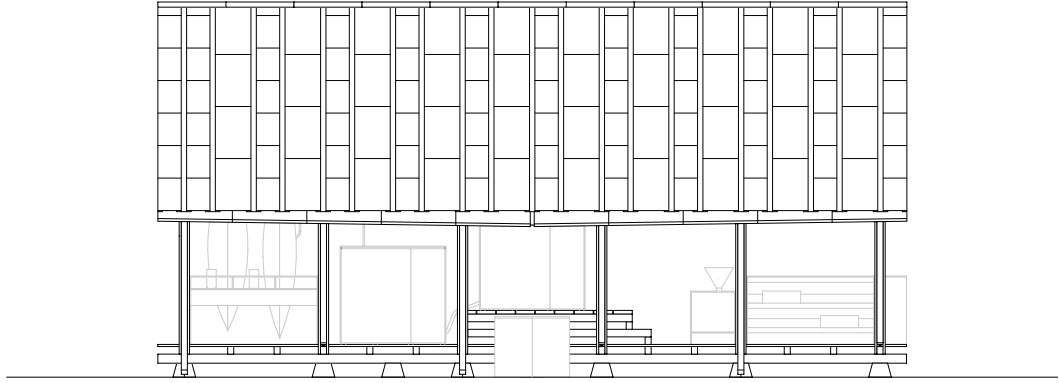













The increasing climate problems call for a more conscious and responsible approach to the planet and its resources. Especially, the fields of building production and architecture are challenged by strong demands for more sustainability.

This is why sustainable strategies in architecture no longer focus exclusively on technological solutions. Durability, adaptability or transformation as well as vernacular building culture are explored with the goal of creating an architecture that is sustainable.

For the building sector, one of the main important aspects is to move towards circular thinking, in which buildings can take on new uses. Structures can be adapted to changing requirements. Materials are durable, can be reused, reassembled or even be reintegrated into 'nature'.

The project ZINNERGIE explores the potential of circular concepts by building a small urban biogas plant using exclusively discarded materials. In this undertaking, we tried to manifest the reuse of materials as a tangible and bodily experience of the architectural artefact itself.

The search for available materials formed the starting point of the project work. Demolished houses function as material archives and suitable building materials were identified and dismantled. We examined and collected discarded building materials from material assortments, whilst existing remainders on site were considered as potential building materials.

The actual designing began by exploring and getting to know the given materials. We explored and tested the inherent properties and structural capacities through the physical interaction with the materials. By following the aim of transforming the technical aspects of construction into an aesthetic dimension we developed a

structure that is simultaneously building the construction, defining the spatial character and creating the architectural expression.

This approach resulted in a robust and adaptable framework that can host and even exhibit the technical infrastructure as well as the actions connected to it. A large roof protects from the rain and at the same time collects it for further uses. It defines the 'face' to the public street. The structure's openness to the other side invites people to enter, explore and interact with the architecture. It activates the square in front as a place of public life.

At the moment the structure is appropriated for the use of the biogas plant but it also allows multiple other uses in the later future. Materials and joints are kept raw and generic in order to allow a future disassembling and a reuse of the materials.

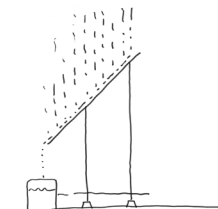
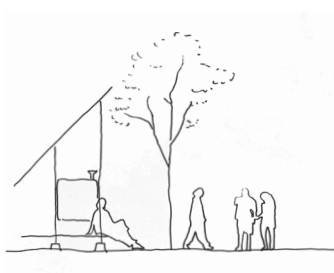
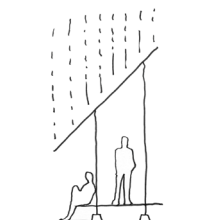
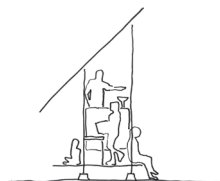

**Multifunctional** allows for appropriation and flexible uses

**Robust** to resist unpredictable bodily interactions

**Protection** a place protected from rain and too much sun

**Public Space** to create a place for the community

**Rainwater Collection** for the daily operation of the plant

**Teaching and Learning Object** the technical infrastructure is exhibited to make it accessible

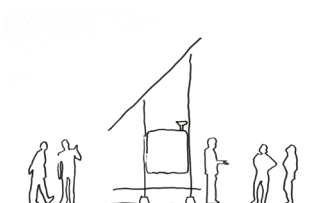

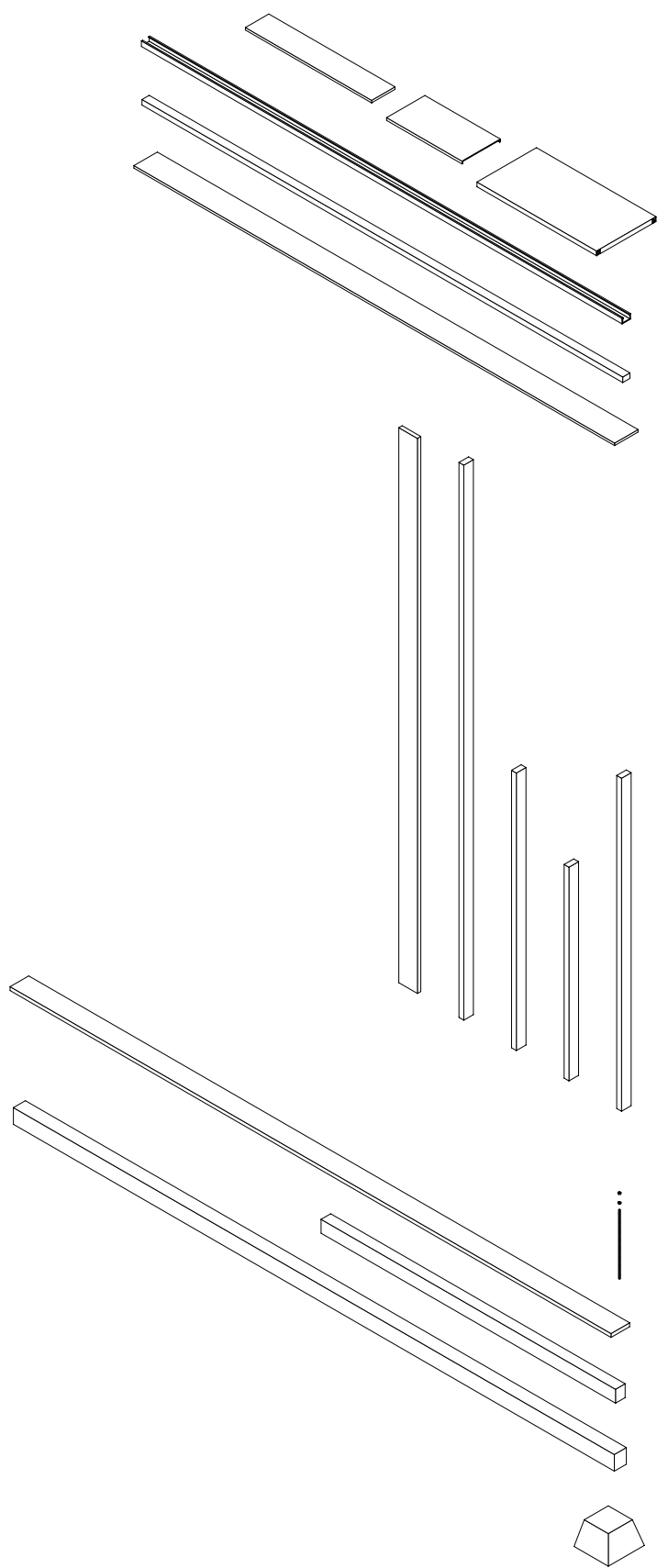



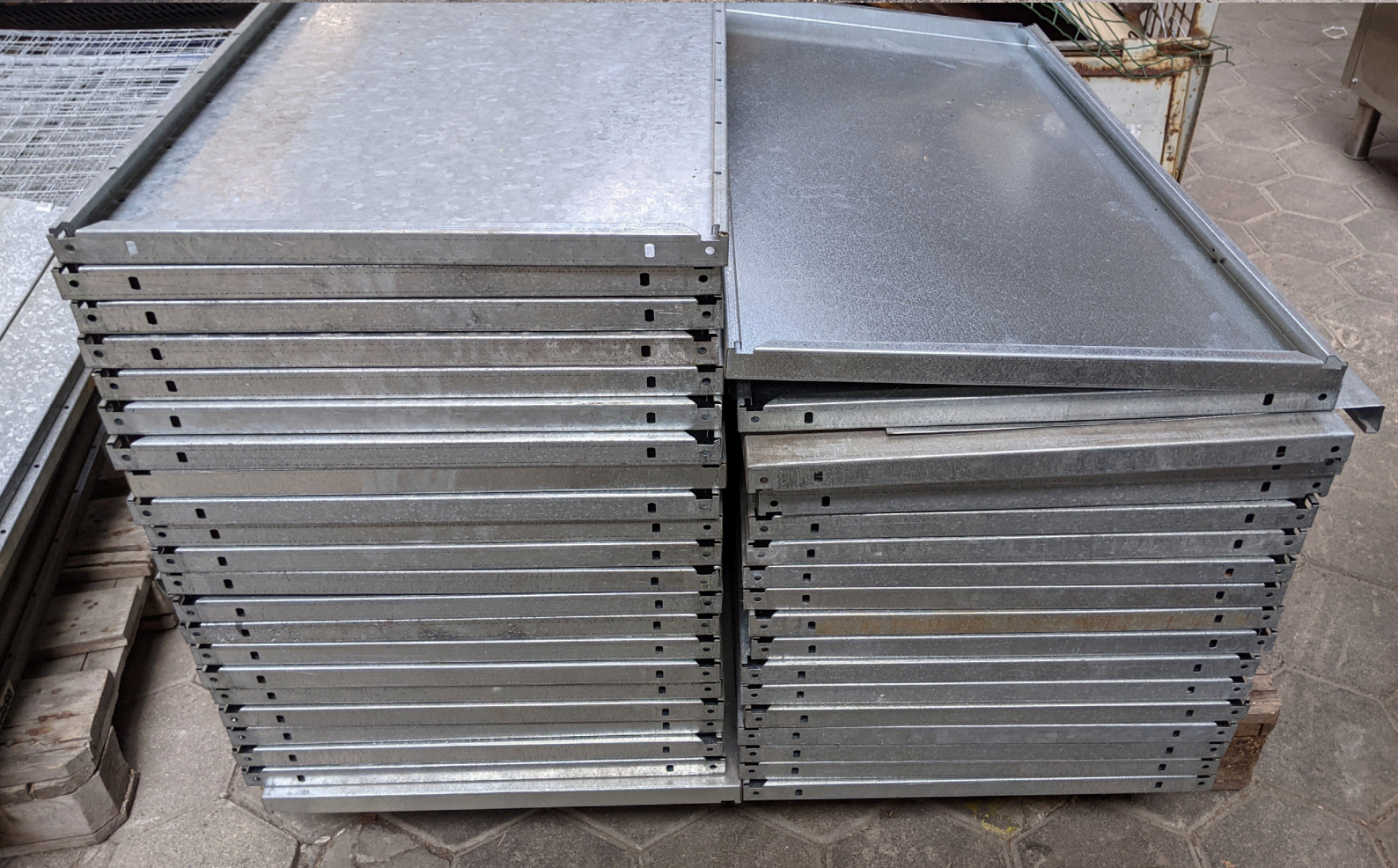





*„The structure should be a meeting point where you bring by your organic waste but also have a cup of coffee.“*







*„The aim of the design is to  
arouse interest and thereby  
bring people into the  
architecture.“*









*„At the end we created  
something really sustainable.“*

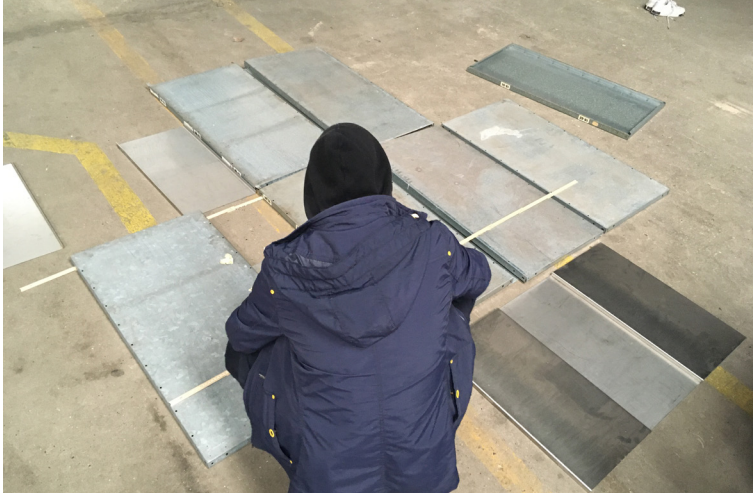







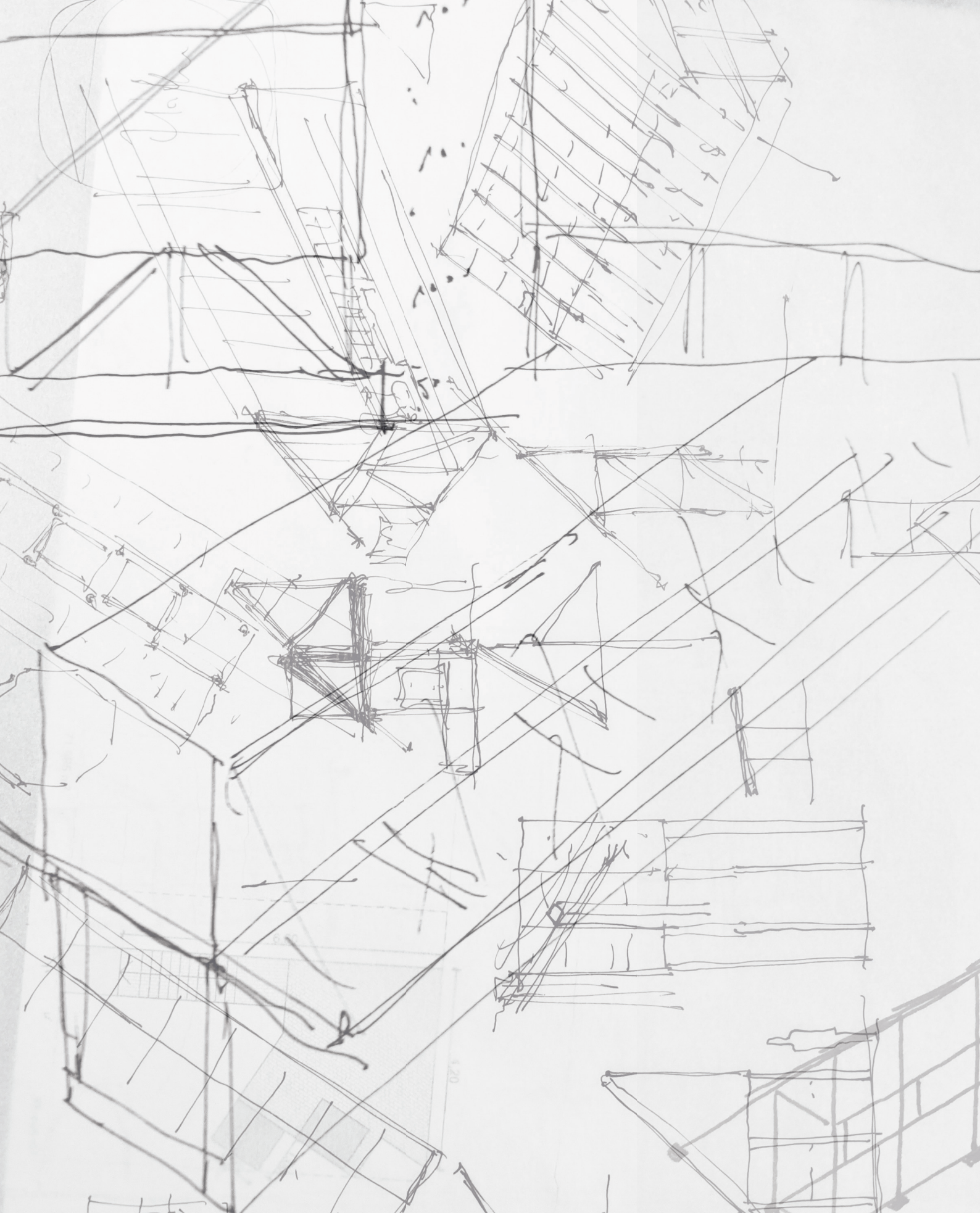



2.5

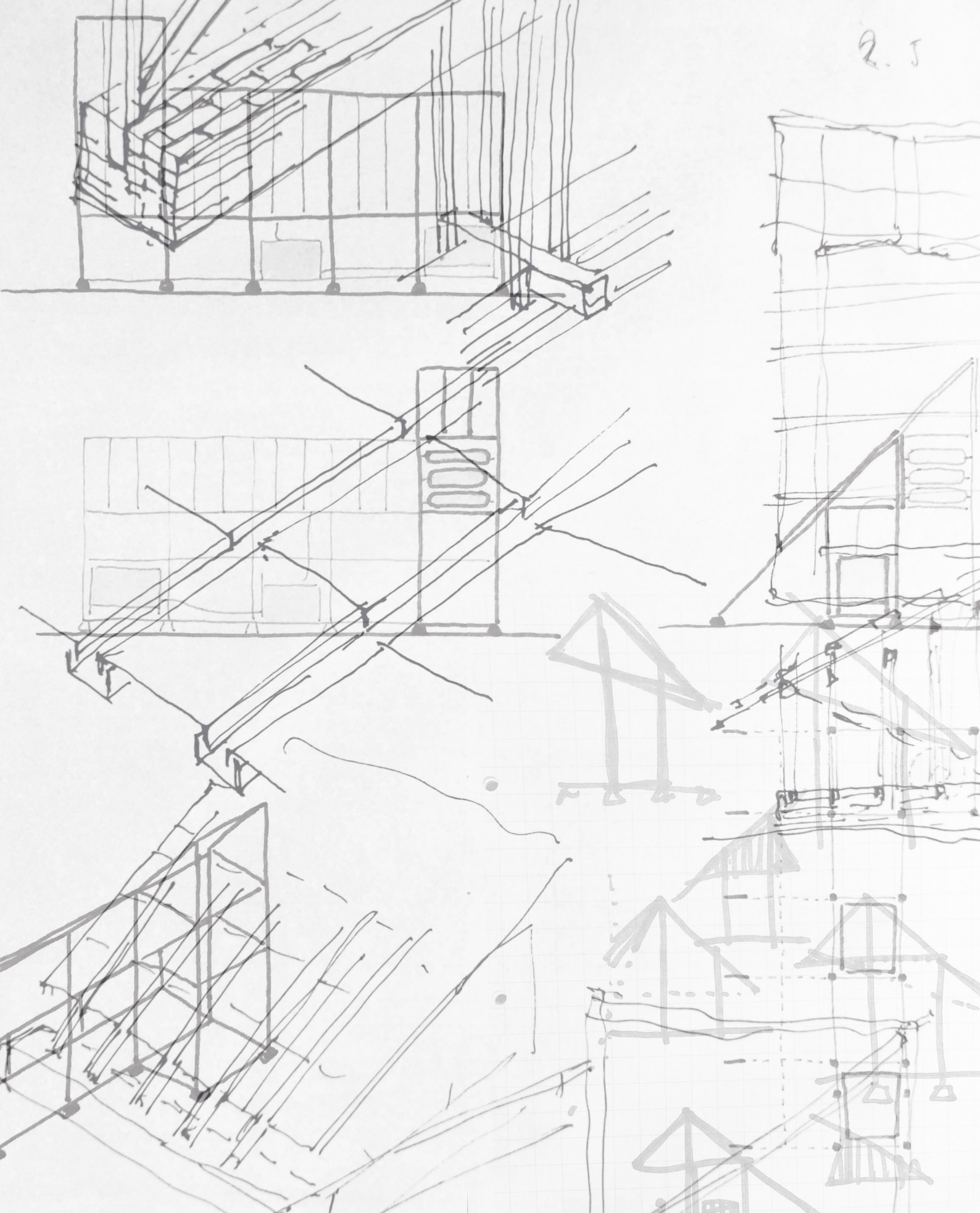







- 1 threaded rods and screw nuts
- 2 wooden boards 2,5x15,5 cm (oiled)
- 3 wooden beams 8x10 cm (oiled)
- 4 wooden beams 10x12 cm (oiled)
- 5 concrete piles 30x30x18,5 cm

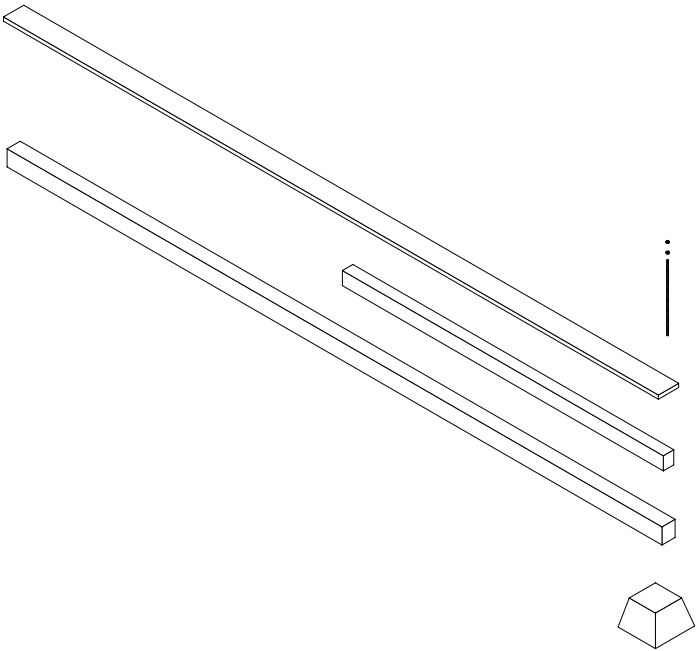

1  
2  
3  
4  
5

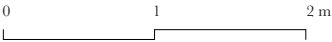







0 1 2 m

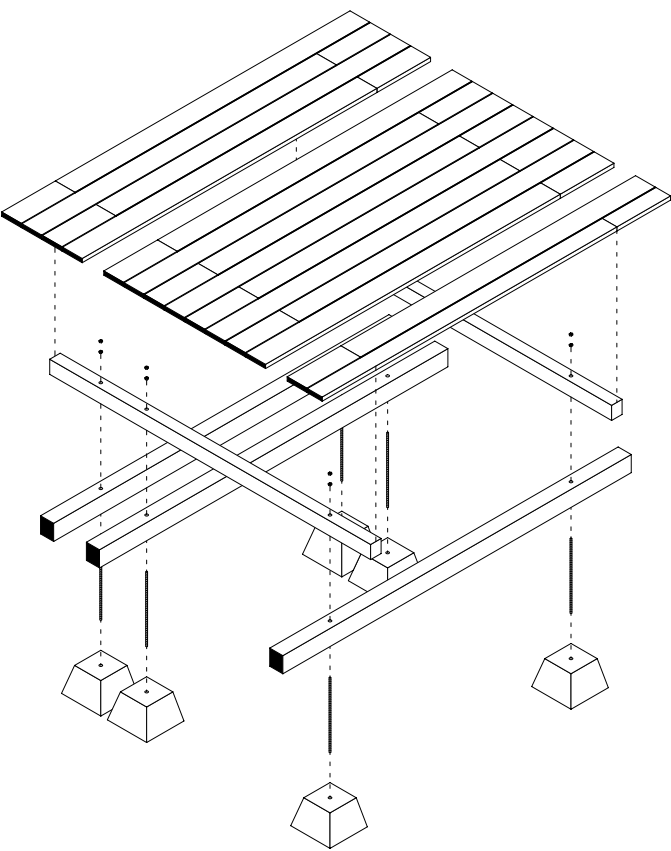







0 1 2 m

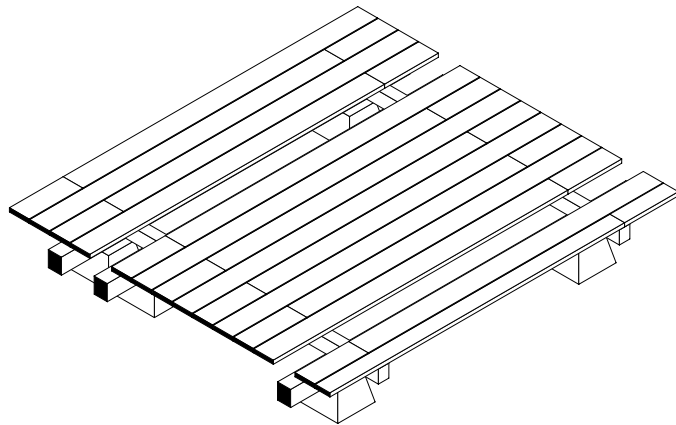



- 1 wooden boards 2,8x15 cm (oiled)
- 2 wooden bars 8x4 cm (oiled)

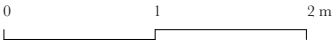
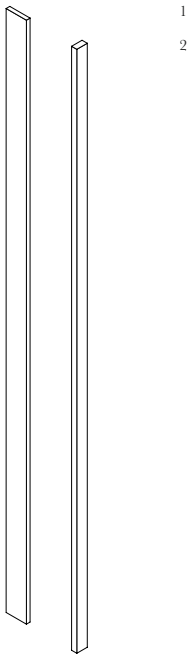







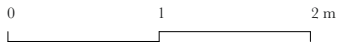
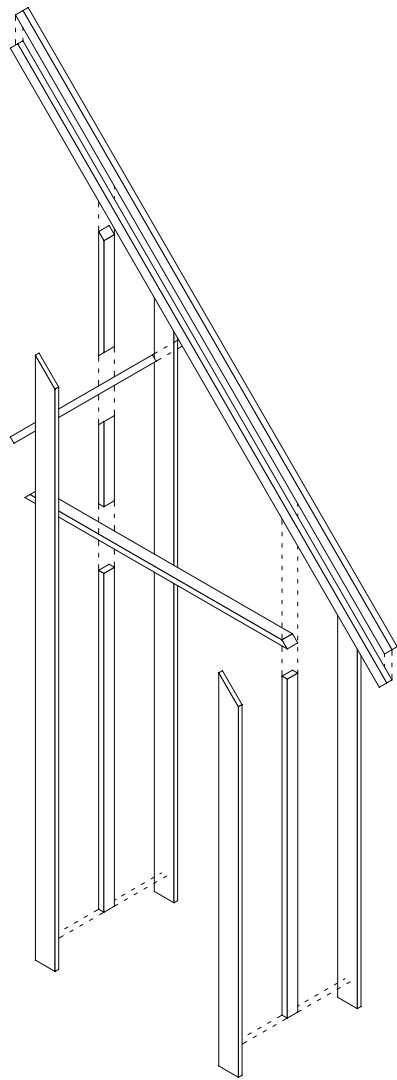







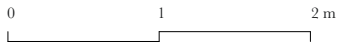
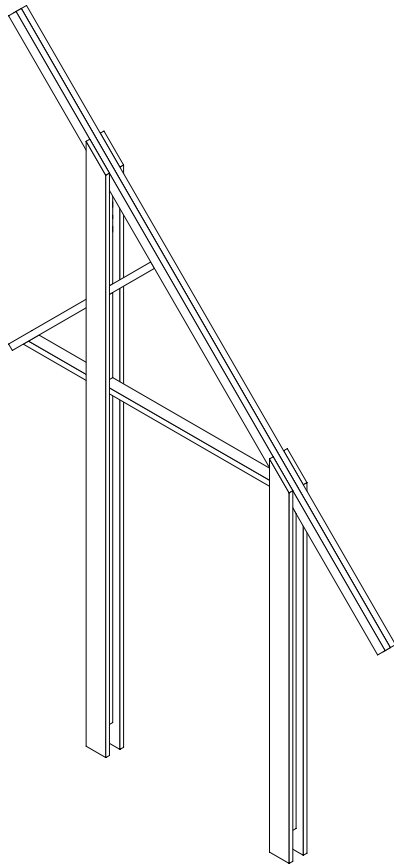











- 1 folded steel sheets (green coated)
- 2 stainless steel boards
- 3 galvanized steel boards
- 4 wooden bars 4x6 cm (oiled)
- 5 drywall profiles
- 6 wooden boards 1,8x19,5 cm (flamed)

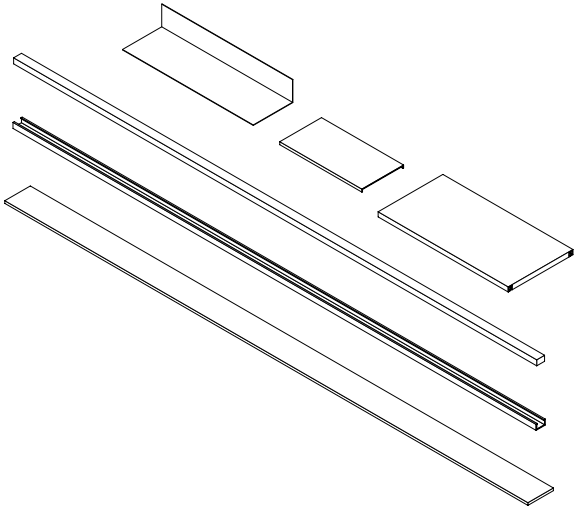

1  
2  
3  
4  
5  
6

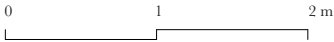







0 1 2 m

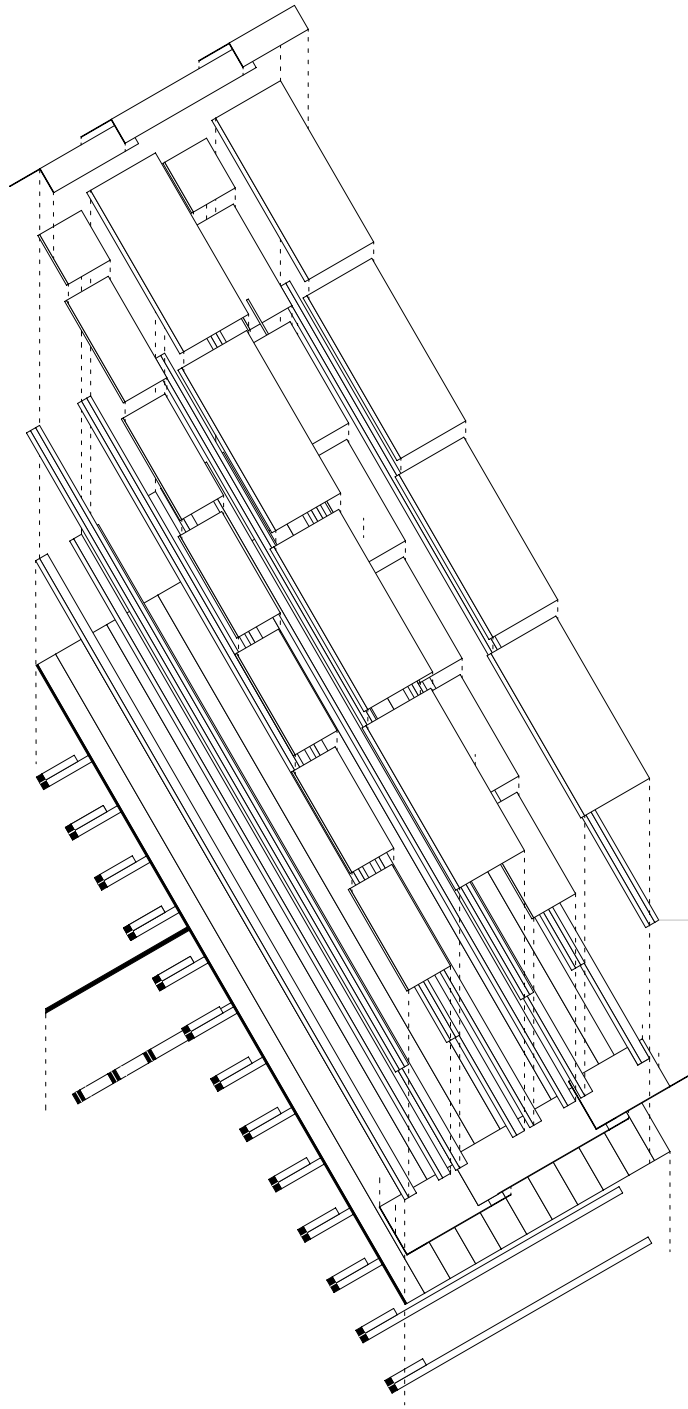







0 1 2 m

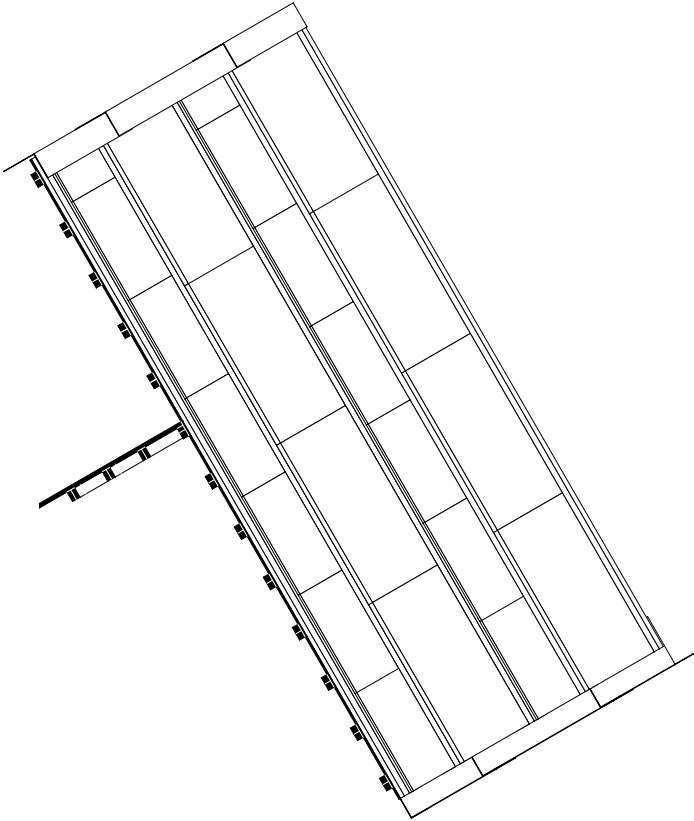



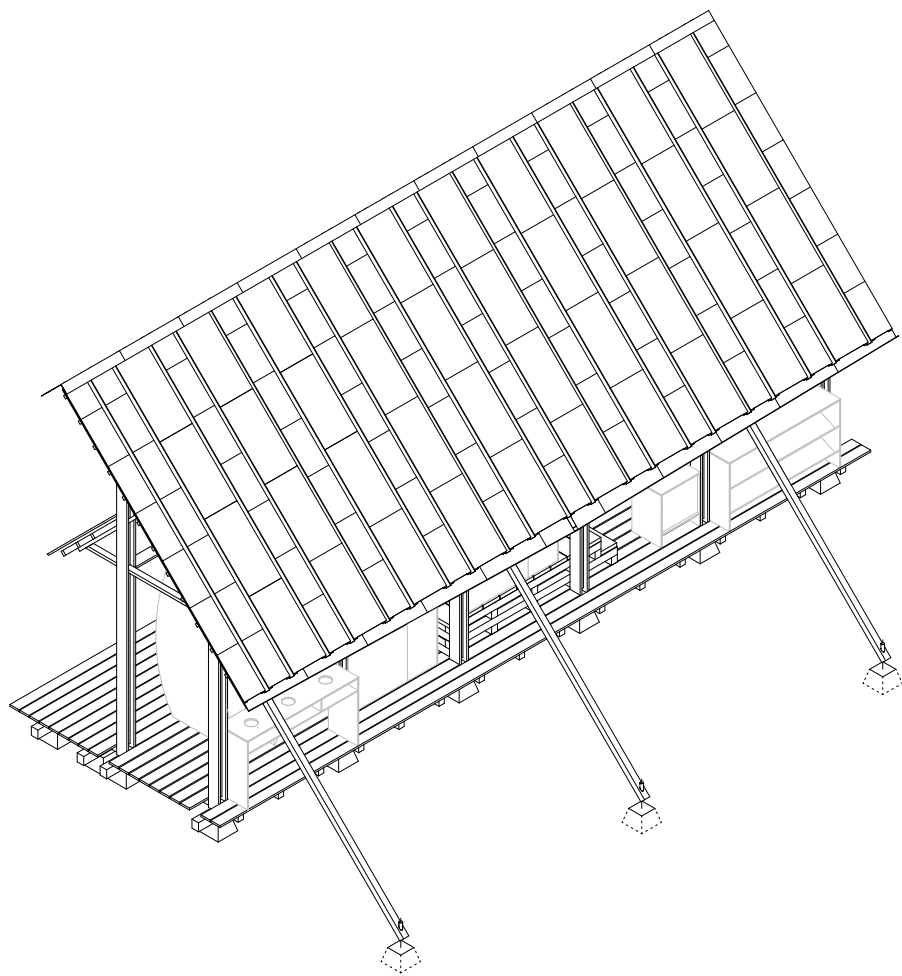

0 1 2 m



Roof

Frame

Base

0 1 2 m

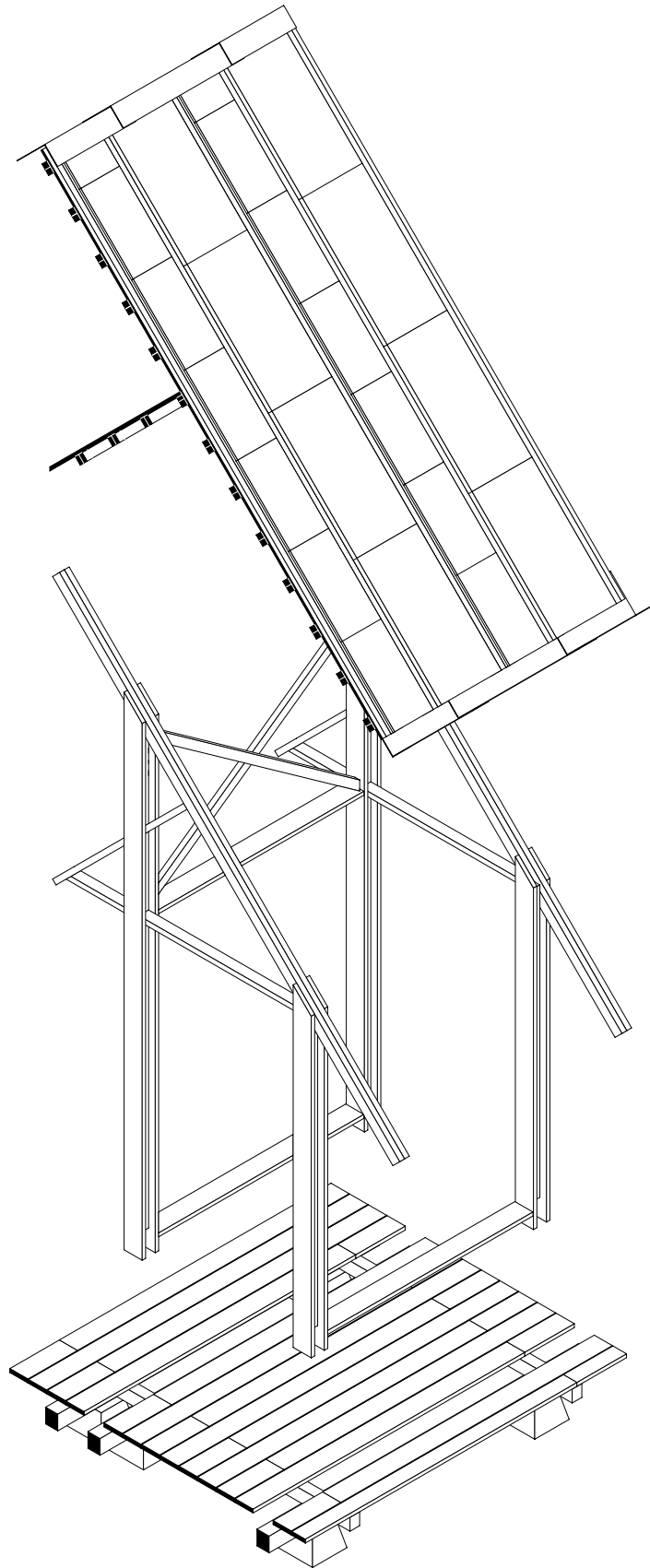



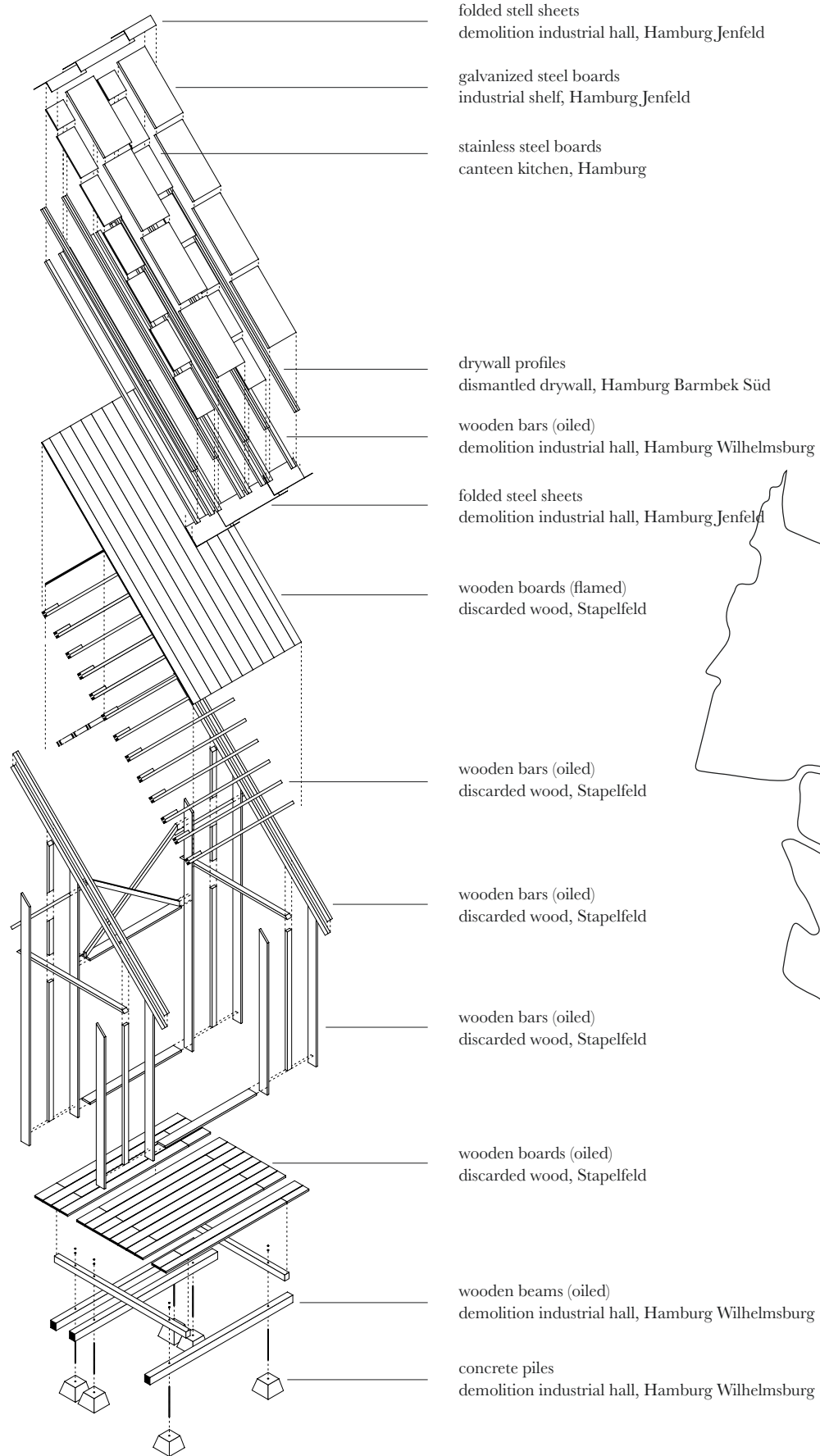



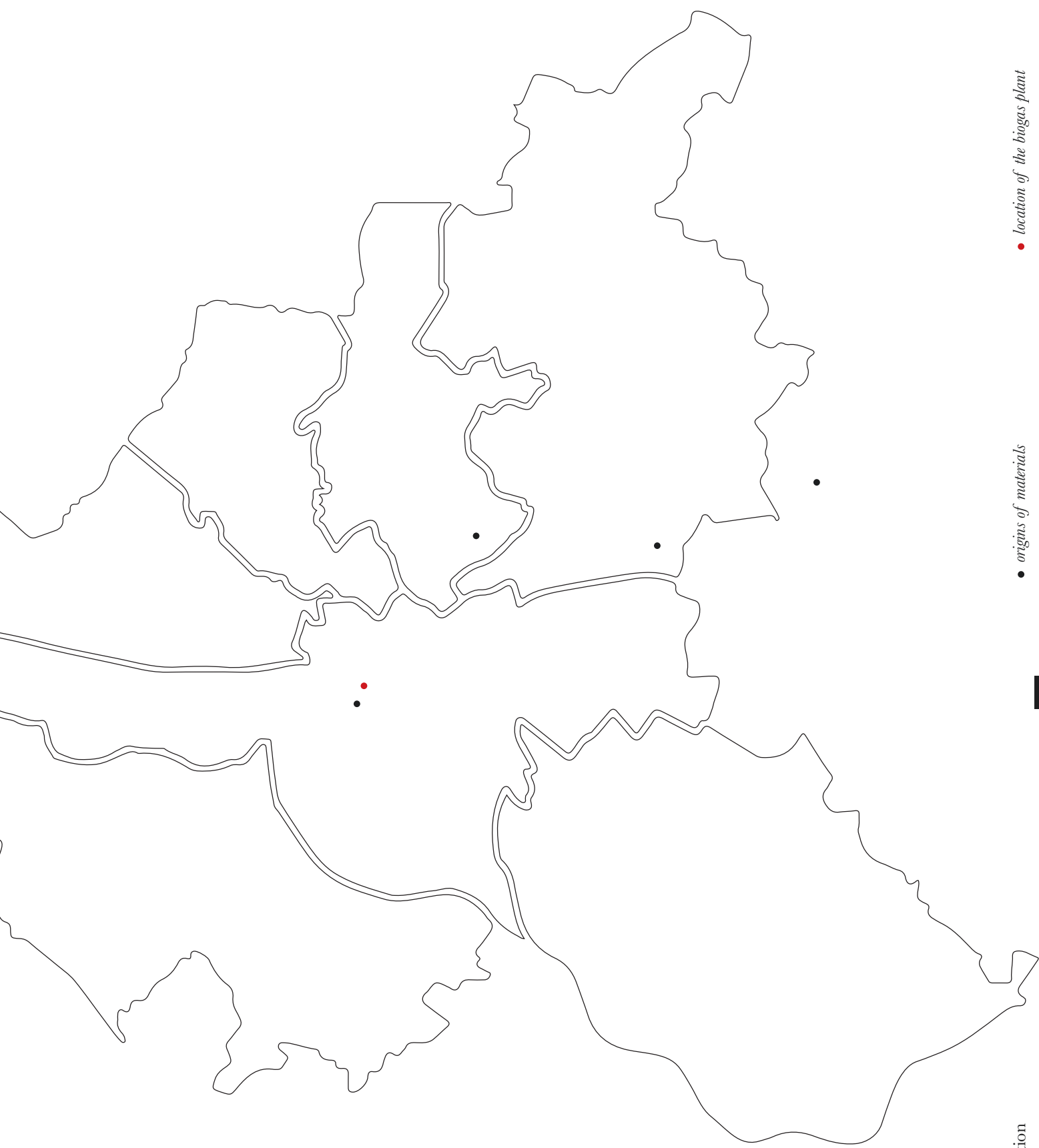





1

organic waste delivery and sorting

2

food sharing

3

shredder and storage

6

liquid fertilizer

7

gas cleaning

8

gas storage





4

filling station

5

biogas production

































Das Baubüro  
im gesamten  
der Baugewerke  
strategische



































## Image credits

## Photographs

pp. 6-23 © Simon Menges  
 pp. 27,29,33© Tim Simon-Meyer  
 pp. 28,32,36,60-75 © Johanna Schmeißer  
 pp. 31,38 © Matthias Ballestrem  
 pp. 30,40,43,45,47-52 © Maischa Souaga  
 p. 44 © Hannah Grapentin  
 p. 76 © Beate Kapfenberger

## Illustrations

© Johanna Schmeißer, Tim Simon-Meyer



first stored biogas \_ 1st September 2022



The project was initiated by Hirn und Wanst GmbH and morgen. Beate Kapfenberger und Martha Starke GbR.

Participating institutions were Hafencity Universität Hamburg (HCU), Technische Universität Hamburg, Hochschule für Angewandte Wissenschaften Hamburg, Universidade Autónoma de Lisboa (UAL) as well as Stadtteilschule Wilhelmsburg.

#### Tutors architecture

Matthias Ballestrem (HCU), Johanna Schmeißer (HCU), Tim Simon-Meyer (HCU + Atelier JQTS) and João Quintela (UAL + Atelier JQTS).

#### Tutors organisation and communication

Annette Schmid, Beate Kapfenberger, Maire Cordts, Martha Starke, Michalea Anderl, Selina Schlez, Sina Jansen and Sören Koswig.

#### Tutors technic

Steffen Walk, Luis-Marcel Vargas Luft and Klaus Willke.

#### Participants

Angelina Zillich, Annina Schreiber, Bjarne Schoel, Charlotte Gotthardt, Franz Kirsch, Hannah Grapentin, Hannah Kettel, Henri Läßle, Inês Pedrosa Vaz, Jasmin Hiller, Jan Lehmann, Johanna Hirte, Lena Stoldt, Leticia Sampaio, Levin Wagner, Marina Vassilieva, Stephannie Hernandez Ostos, Sonja Lattwesen, Tessa Goliasch, Thi Thanh Nhan An, Thomas Volavsek and Tim Garbers.

Specials thanks to Behörde für Umwelt, Klima, Energie und Agrarwirtschaft, BI Elbinsel GmbH, Boris Gusic, Eisen Jens, Festool, Filmpolizei, HOFA Holzimport GmbH, Ingenieurbüro Sebastian Selk, Julia Kaiser, Konspiratives KulturKollektiv e.V., Material Cultures, morgen. Beate Kapfenberger und Martha Starke GbR, Norell/Rohde, Studio 17, Studio Errante Architettura, Zinnwerke e.V. and to all students!

Among others, the project was made possible through the financial support of Sto-Stiftung, waterfront e.V. and Hans Sauer Stiftung.

This publication was generously funded by Sto-Stiftung.











Copyright                      Hafencity Universität Hamburg, 2022

ISBN (print)                      978-3-947972-53-1

ISBN (Ebook)                      978-3-947972-54-8

DOI                                  10.34712/142.33

Editors                              Matthias Ballestrem,  
Tim Simon-Meyer,  
Johanna Schmeißer

Graphic Design                      Johanna Schmeißer